



### 43 Bennett Street Malmsbury VIC

4 🏠 2 🚗 1 🚗

Discover the epitome of countryside living with urban convenience at 43 Bennett Street, Malmsbury. Set on a substantial land size of approximately 956m<sup>2</sup>, complemented by an additional 3000m<sup>2</sup> of leased land, this property offers a rare opportunity to immerse yourself in the beauty of Malmsbury's landscape while enjoying proximity to the township.

**Price** : \$750,000 - \$825,000  
**Land Size** : 956 sqm  
**View** : <https://www.bendigorealestate.com.au/sale/vic/greater-bendigo-region/malmsbury/residential/house/7916394>

Nestled amidst the serene Malmsbury countryside, this home boasts uninterrupted views that stretch as far as the eye can see. The perfect fusion of rural tranquility and urban accessibility makes this residence truly exceptional.

Newly renovated throughout, the property exudes modern elegance while preserving its timeless charm and ensuring a seamless blend of style and sophistication.



**Toby Gray**  
03 5441 4555

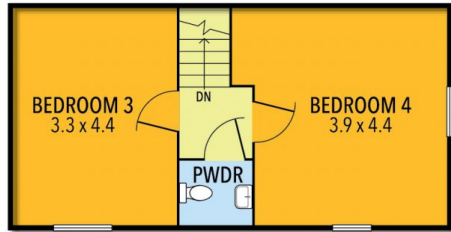

FIRST FLOOR



GROUND FLOOR

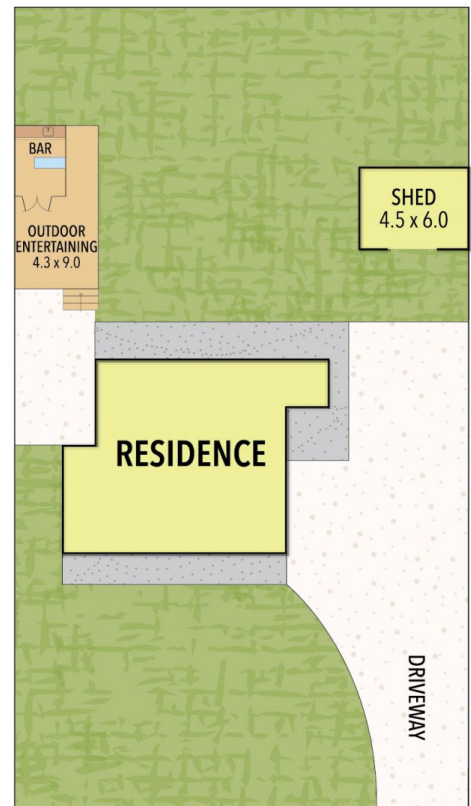

INT	: 168 M <sup>2</sup>
SHED	: 27 M <sup>2</sup>
OUTDOOR	: 39 M <sup>2</sup>
VERANDAH	: 63 M <sup>2</sup>
TOTAL APPROX	: 297 M <sup>2</sup> ( 32 SQUARES)



THE ABOVE PLAN IS AN ARTIST'S IMPRESSION ONLY, IT INCLUDES ELEMENTS THAT ARE FOR DISPLAY PURPOSES ONLY AND MAY NOT BE TO SCALE. LANDSCAPING SHOWN IS INDICATIVE ONLY. DIMENSIONS ARE APPROXIMATE.