



9 Rosemary Avenue Strathdale VIC

4 2 2

Welcome to 9 Rosemary Avenue - a masterpiece of contemporary living in a serene suburban setting. This stunning designer 4-bedroom family home promises a lifestyle of sophistication and comfort, boasting a range of features that elevate it to a league of its own.

Price : \$ 685,000
Land Size : 661 sqm
View : <https://www.bendigorealestate.com.au/sale/vic/greater-bendigo-region/strathdale/residential/house/7939971>

The unique design elements scattered throughout the home contribute to its individual character, making it a truly one-of-a-kind property.



Toby Gray
03 5441 4555

Sunlight streams throughout, creating a beautiful and light-filled atmosphere that sets the tone for daily life.

The heart of the home is a decked courtyard, an enchanting space designed to be the central focus. This area not only serves as an outdoor oasis but also doubles as a designer centerpiece, making it an ideal spot for gatherings or private relaxation.

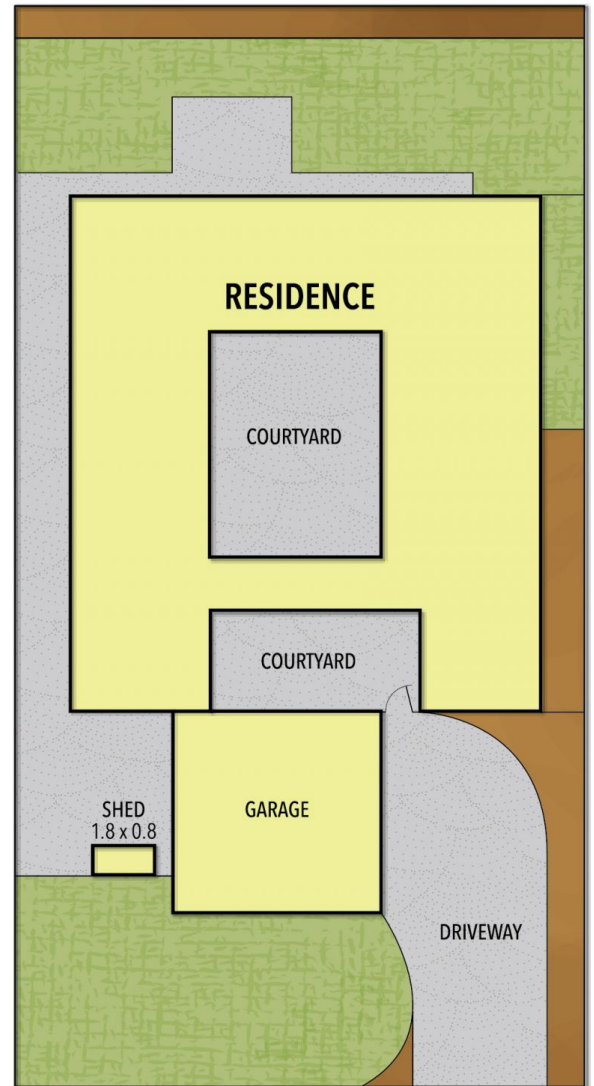
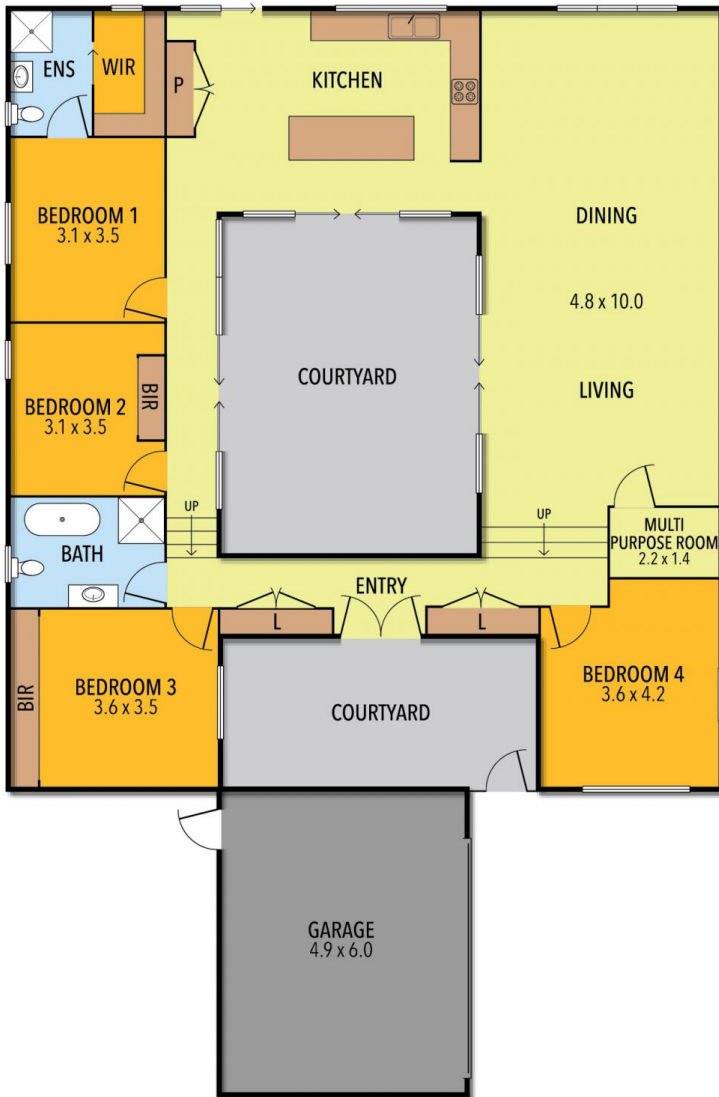

INT	: 173 M ²
GARAGE	: 29 M ²
COURTYARD	: 56 M ²
SHED	: 2 M ²
TOTAL APPROX	: 260 M ² (28 SQUARES)

THE ABOVE PLAN IS AN ARTIST'S IMPRESSION ONLY, IT INCLUDES ELEMENTS THAT ARE FOR DISPLAY PURPOSES ONLY AND MAY NOT BE TO SCALE. LANDSCAPING SHOWN IS INDICATIVE ONLY. DIMENSIONS ARE APPROXIMATE.