



5 Strathdale Crescent Strathdale VIC

3 1 2

Be prepared to be delighted when you step inside this fun and fresh 1970s home. It's been given a total revamp over recent years with a contemporary fit out to compliment some wow-factor original features.

The home presents a smart façade behind large, lush ornamental pears, which are poised to put on their autumn show. A carport with roller door, a crisply rendered front and freshly-painted eaves & fascia's precede the high entrance way.

Open the front door to a soaring cathedral ceiling with exposed beams overhead and brand-new floor coverings underfoot.

Chic grey-toned vinyl plank flooring and charcoal carpet are the most recent additions to what has been a labour of love

Price : \$590,000 - \$615,000
Land Size : 700 sqm
View : <https://www.bendigorealestate.com.au/sale/vic/greater-bendigo-region/strathdale/residential/house/7971073>



Paul Byrne
03 5441 4555

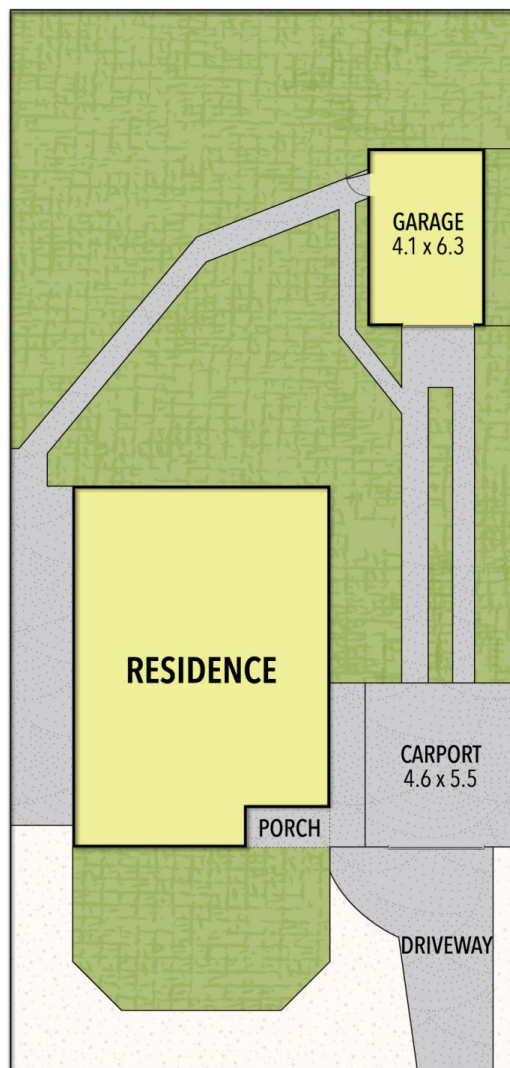
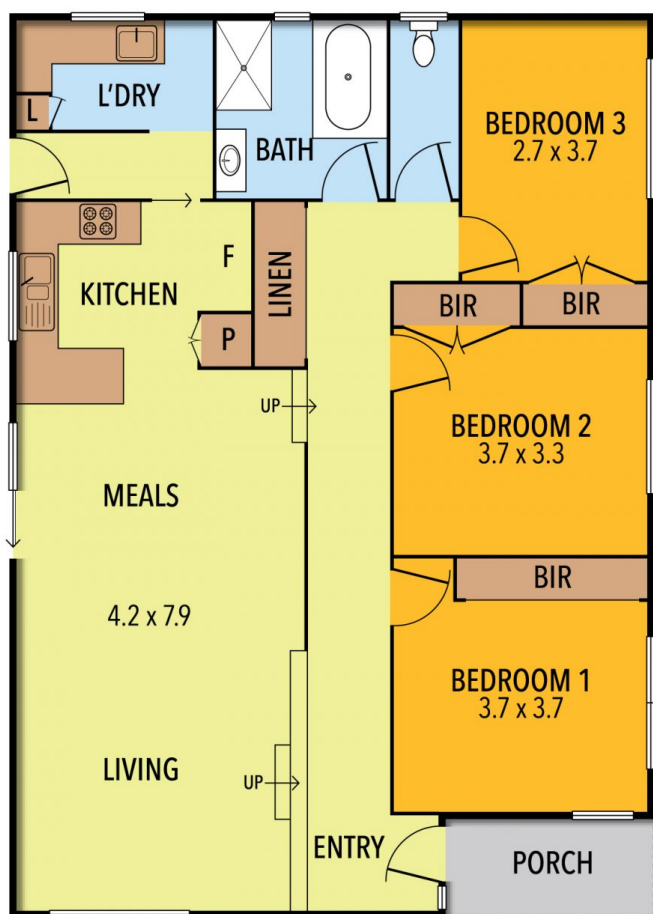

INT	: 118 M ²
GARAGE	: 26 M ²
PORCH	: 5 M ²
CARPORT	: 25 M ²
TOTAL APPROX	: 174 M ² (18 SQUARES)



THE ABOVE PLAN IS AN ARTIST'S IMPRESSION ONLY, IT INCLUDES ELEMENTS THAT ARE FOR DISPLAY PURPOSES ONLY AND MAY NOT BE TO SCALE. LANDSCAPING SHOWN IS INDICATIVE ONLY. DIMENSIONS ARE APPROXIMATE.