



**205 Holdsworth Road North Bendigo VIC**

3 1 4

This handsome two-toned cream brick home comes with all the charm and warmth of having been loved throughout the decades.

Take one step past the twisted wire front fence and enter a lush and leafy sanctuary that you simply won't want to leave.

The period façade with its feature brick chimney includes an elevated front porch of ornate wrought iron; the perfect place for morning cuppas and enjoying the changing garden.

Open the front door to a host of original features that are just as coveted today as when this home was first built,

[For full version visit the website](https://www.bendigorealestate.com.au)

**Type** : House  
**Price** : \$ 600,000  
**View** : <https://www.bendigorealestate.com.au/sale/vic/greater-bendigo-region/north-bendigo/residential/house/8246541>



**Neki Tzouroutis**  
03 5441 4555



**Matt Gretgrix**  
03 5441 4555

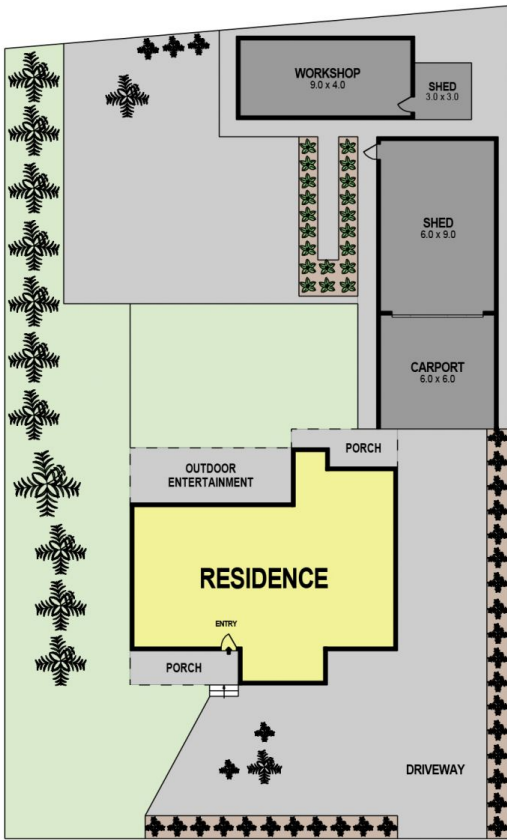

**SITE PLAN**  
(NOT TO SCALE)



**GROUND FLOOR**

INT	:	132m <sup>2</sup>
SHED	:	63m <sup>2</sup>
PORCH	:	19m <sup>2</sup>
CARPORT	:	36m <sup>2</sup>
WORKSHOP	:	36m <sup>2</sup>
OUTDOOR ENTERTAINMENT	:	26m <sup>2</sup>
TOTAL APPROX	:	312m <sup>2</sup>

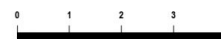

**SCALE (METRES)**



THE ABOVE PLAN IS AN ARTIST'S IMPRESSION ONLY, IT INCLUDES ELEMENTS THAT ARE FOR DISPLAY PURPOSES ONLY AND MAY NOT BE TO SCALE. LANDSCAPING SHOWN IS INDICATIVE ONLY. DIMENSIONS ARE APPROXIMATE.

Ref. No: 250130